

MC-080-02/LED Flood Light

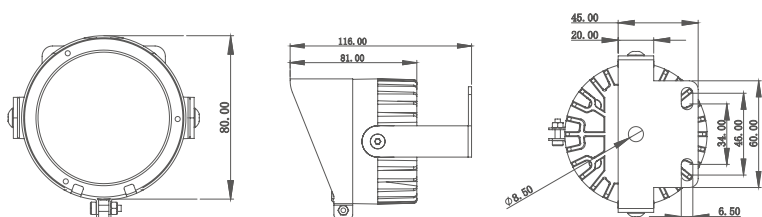

Size:



MC-080-02/LED Flood Light

Features:

1. Mini / minimalist lamp body with design patent conforms to modern industrial aesthetic standard
2. The whole structure waterproof adopts mechanical pressure locking silica gel pad technology to ensure high and low temperature durability
3. Special ultra long distance precise projection technology and 93% light transmittance ultra white toughened glass
4. Adopt die-casting aluminum lamp body and composite metal high efficiency heat dissipation patent technology
5. Standard 304 stainless steel damping rotating bracket with locking function

Parameter:

Lamp Parameter		LED parameter	
Beam Angle	10° 20° 30° 45° 60°	LED chip	Cree
Case material/color	Dia-casting aluminum (black)	LED Item	XTE/CLQ6A
Cover material/color	Ultra clear tempered glass	CCT	Single color/RGBW
IP rate	IP66 structure waterproof	LED Power	5W
Lamp Power	6W-12W	Other Parameter	
Input Voltage	DC24V	Cable size	2 pins 1.5mm ² rubber cable
PF	0.9	Cable length	300mm
Light Efficiency	85lm/w(white)	Fixing clip	Die-casting aluminum
Light angle	180°adjustable	Light distribution	
Cable location	From the bottom		
Control way	ON-OFF /DMX512		
Environment temperature	-30°C~+35°C		